

# WALK IN SHOWER SERIES

## WALK-IN SHOWER ONE PANEL - HALF FRAMED

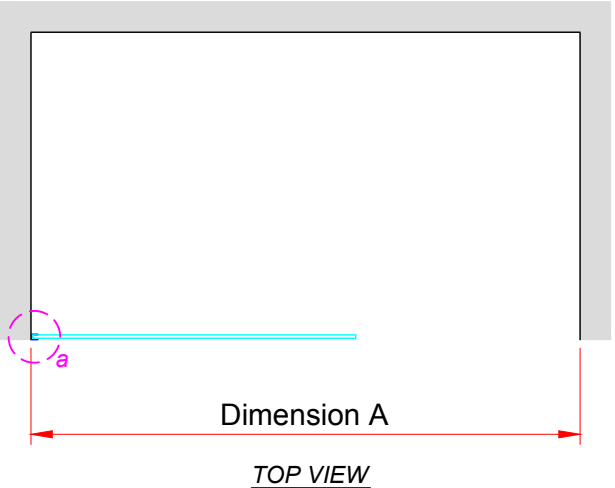

## WALK-IN SHOWER TWO PANELS - HALF FRAMED

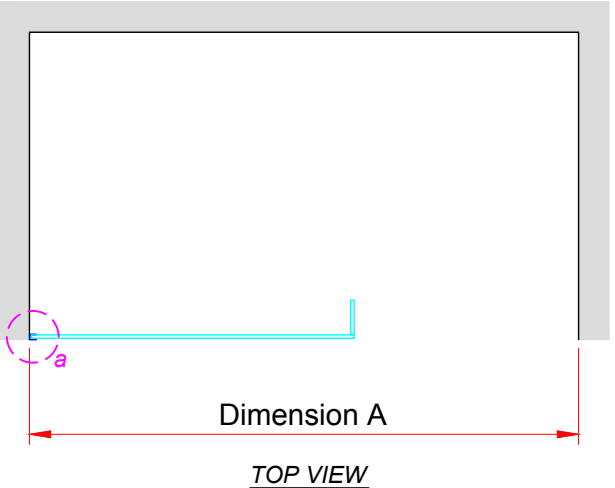

## WALK-IN SHOWER ONE PANEL - FULL FRAMED

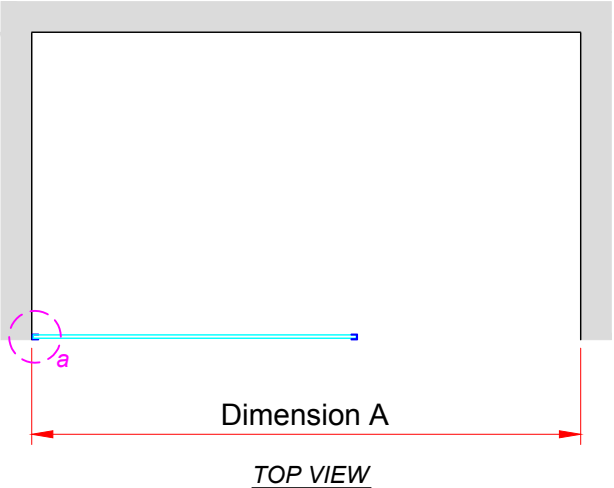

### Important:

Before you install your project, please read this installation guide carefully, consider the gap between each part, calculate the exact length before cutting.

The corners and edges of toughened glass are its weakest points, so ensure they are well-protected during installation.

Always use rubber spacers to separate stainless steel hardware from the glass to avoid damage.

After completing the installation, it is essential to clean both the glass and the hardware. Proper cleaning of the glass helps maintain its protective coating, and cleaning the hardware removes any metal debris from the installation process, preventing potential rust.

Additionally, regular cleaning afterward is recommended to ensure long-term durability and maintain optimal performance.

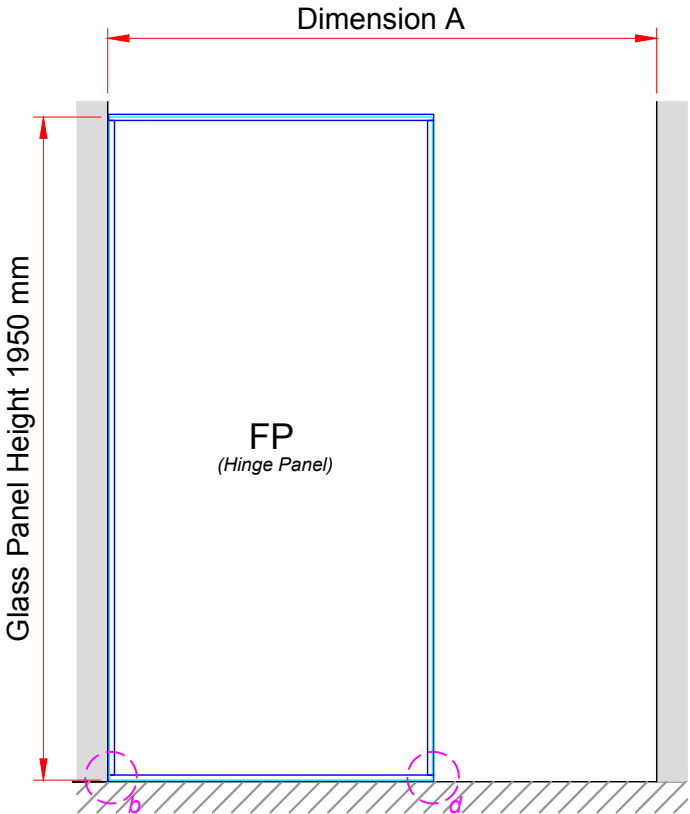
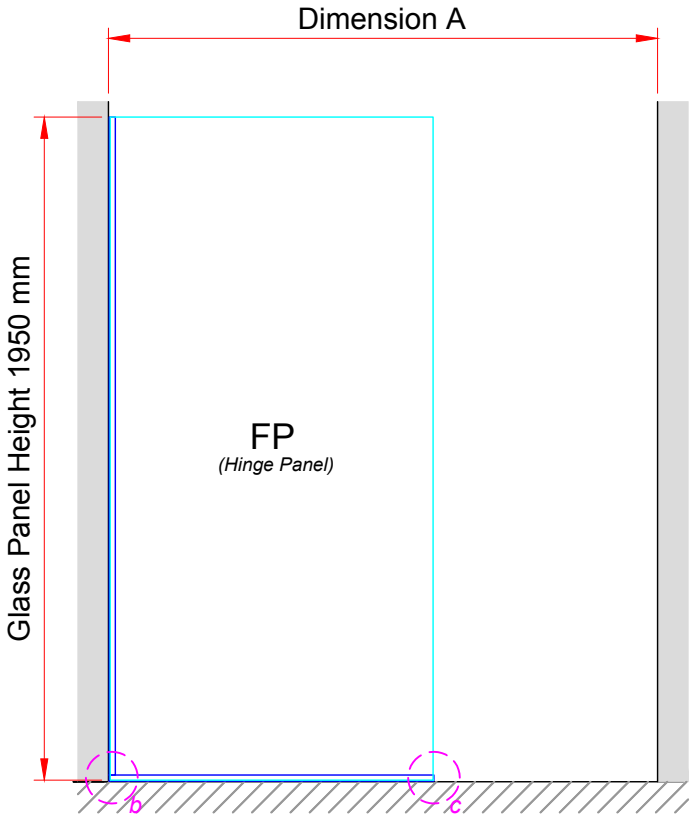
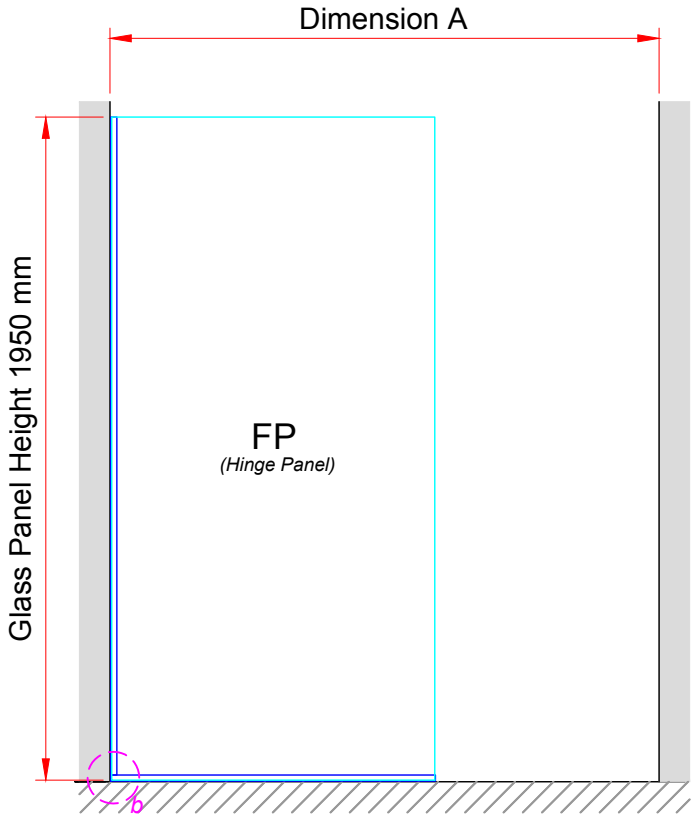

### LEGEND

Dimension A	The overall dimension including gaps between wall and all glass panels ( $\pm 1$ mm to all gaps recommended).
FP	Flat Panel
a	Wall, channel, rubber and glass panel fixing detail
b	Gap between door and hinge panel
c	Gap of door on handle side
d	Floor channel and wall channel joint
e	Gap between door and floor
f	Gap between door and return panel
g	Flat panel 90° joint

For more detailed information, please contact the team: email [sales@grandglass.co.nz](mailto:sales@grandglass.co.nz) ph 09 478 9778 or 027 755 7705 [www.grandglass.co.nz](http://www.grandglass.co.nz)

FIXING DETAIL

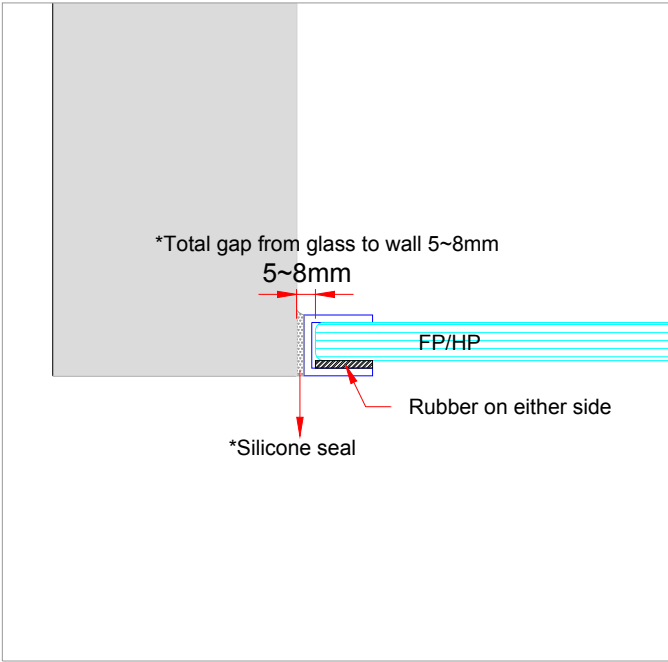

FIXING DETAIL a

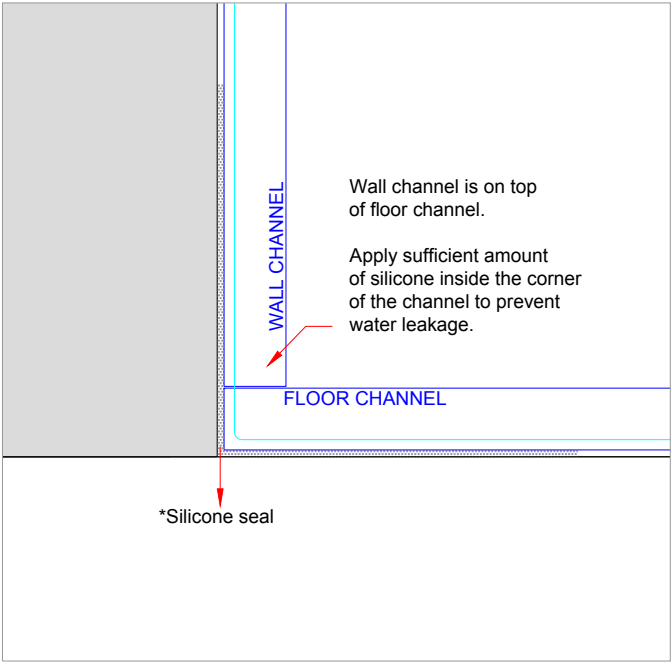

FIXING DETAIL b

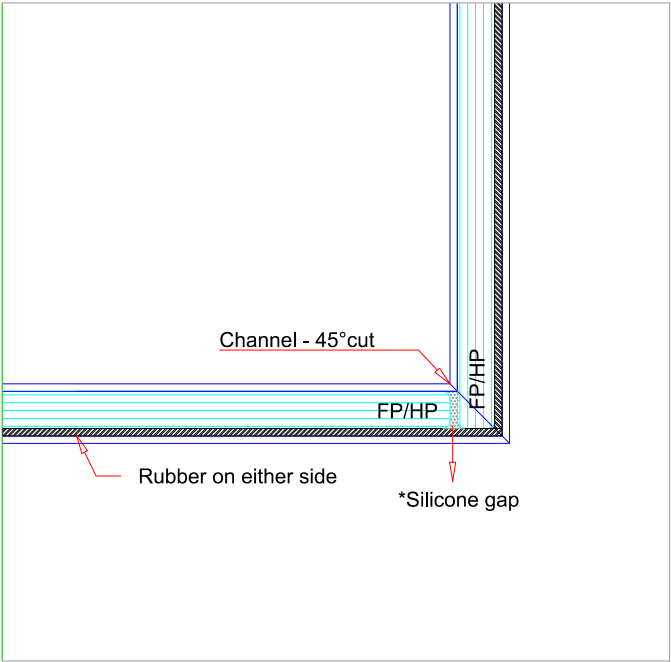

FIXING DETAIL c

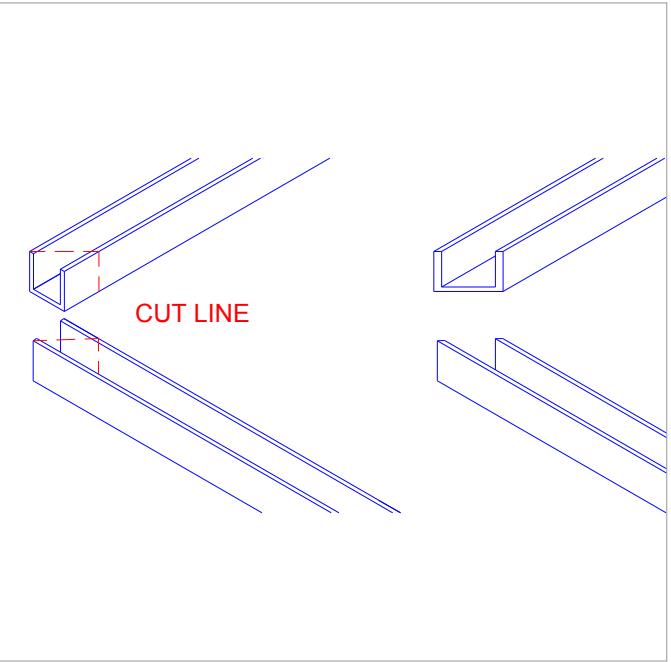

CHANNEL 45° JOINT

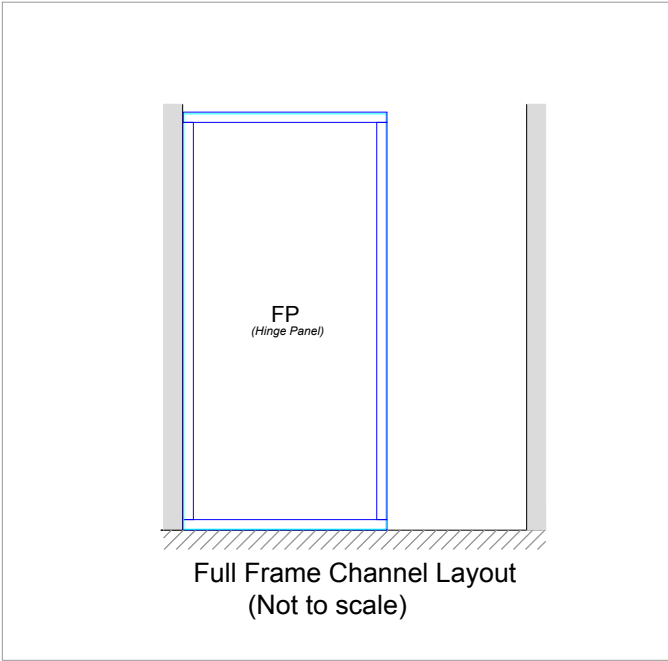

FIXING DETAIL d